



DOUBLETREE GUEST SUITES® DOHENY BEACH

DANA POINT

DOUBLETREE GUEST SUITES DANA POINT, CALIFORNIA



LOCATION

Midway between Los Angeles and San Diego, the Doubletree Guest Suites Doheny Beach

resides in a quaint seaside community perfect for a relaxing escape or business conference. Located along Pacific Coast Highway, we are just a stroll to the beach and within an hour from Sea World®, Legoland®, Disneyland® Resort, Universal Studios HollywoodSM and Knott's Berry Farm.

FACILITIES & SERVICES

- 195 recently renovated suites, including ocean views and Riviera Suites
- 4,700 square feet of flexible indoor and outdoor meeting space
- Business center
- On-site executive transportation services
- Safe-deposit boxes
- Laundry/valet service
- Gift shop
- Pet friendly

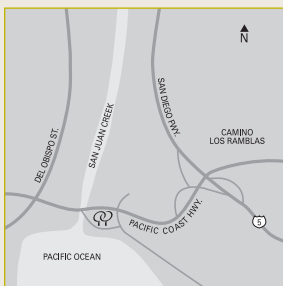

Doubletree Guest Suites Doheny Beach

34402 Pacific Coast Highway
Dana Point, CA, 92629
Dial Direct: (949) 661-1100
Fax: (949) 489-0628

www.dohenybeach.doubletree.com
1-800-222-TREE

ALL ROOMS FEATURE

- Spacious guest suites with French doors to adjoining living area
- Sweet Dreams® by Doubletree sleep experience
- Wireless high-speed Internet access
- Two televisions with cable, in-room movies and Nintendo® system
- Two telephones with voicemail and dataport
- Wet bar, mini refrigerator and microwave
- Iron/ironing board; hair dryer
- Sweet Dreams alarm clock with MP3 connectivity
- Coffeemaker with complimentary coffee and tea
- USA Today® delivered each weekday morning

MEETING ACCOMMODATIONS

- Award-winning sales and catering services staff
- State-of-the-art audiovisual equipment available
- Wired and wireless high-speed Internet access available in meeting rooms and public areas
- Fax and photocopying services available

RECREATION

- State-of-the-art fitness center
- Sparkling courtyard pool
- Sauna and outdoor whirlpool spa
- Whale-watching, sports fishing and Catalina Island tours available
- Beach, hiking, fishing, scuba diving, golf course and tennis court nearby
- Team-building activities for groups nearby

DINING & ENTERTAINMENT

- For fine dining, Tresca offers an enticing selection of superb entrees such as fresh seafood, steaks, pastas and freshly made pizzas to enjoy either poolside or indoors in our colorful exhibition dining room

- Vivo Bar, an open-air patio, is a perfect place to unwind, savoring breathtaking views of the Pacific Ocean and enjoying a light menu and happy hour
- Room service available

SURROUNDING ATTRACTIONS

- Beaches – 0.1 miles
- Doheny Beach State Park – 0.2 miles
- Dana Point Harbor – 0.2 miles
- Orange County Ocean Institute – 2 miles
- Mission San Juan Capistrano – 5 miles
- Laguna Beach – 5 miles
- Catalina Island – 20 miles
- Orange County Airport – 20 miles
- Legoland® – 29 miles
- Knott's Berry Farm – 37 miles
- Disneyland® Resort – 40 miles
- San Diego Zoo – 60 miles
- Los Angeles International Airport – 60 miles
- Sea World® – 60 miles
- San Diego International Airport – 65 miles
- Universal Studios HollywoodSM – 66 miles

HILTON HHONORS®

- Hilton HHonors is the only hotel guest reward program that lets you earn both hotel points & airline miles for the same stay at more than 2,800 hotels worldwide.
- With the Hilton HHonors Event Planner program, event planners can earn Points & Miles® for qualifying events. Ask your sales person for details.



Hilton HHonors
Points & Miles®

Warm chocolate chip cookies await you at over 175 Doubletree locations in the USA, Canada & Latin America.

The **Hilton** Family



DOUBLE TREE
GUEST SUITES®
DOHENY BEACH

DANA POINT

MEETING & BANQUET
FACILITIES & CAPACITIES

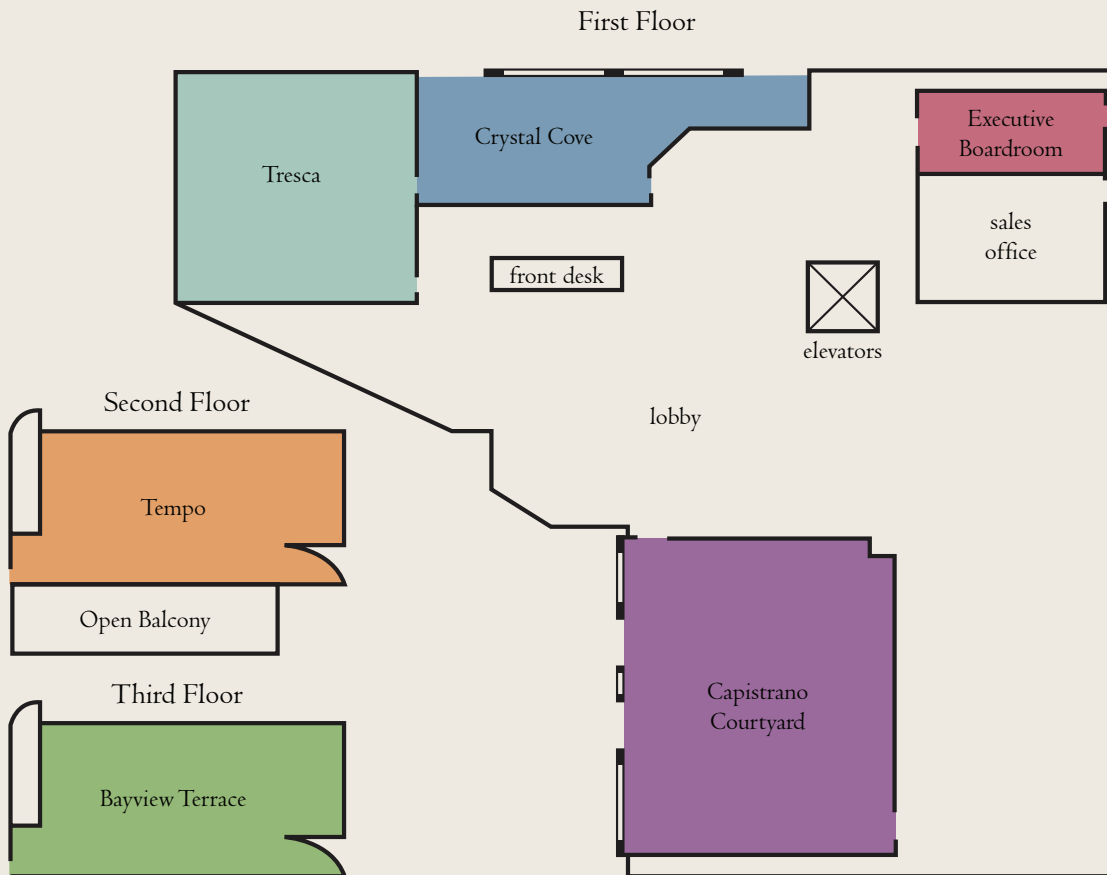

Name of Room	Sq. Ft.	Dimensions	C/R	Theater	Banquet	Reception	Conference	U-Shape	H-Sq.
Capistrano Courtyard	1,056	33' x 32'	50	100	80	115	36	30	32
Crystal Cove	717	22' x 36'	36	65	50	80	27	34	34
Tempo	573	31' x 19'	30	60	40	65	24	21	28
Bayview Terrace	573	31' x 19'	30	60	40	65	24	21	28
Executive Boardroom	290	11' x 26'	-	-	-	-	14	-	-
Tresca	2,268	54' x 42'	-	-	80	-	-	-	-
Vivo Outdoor Terrace (not shown)	1,500	48' x 39'	-	-	75	100	-	-	-
South Palm Deck (not shown)	1,584	48' x 33'	-	-	60	-	-	-	-
Sunset Deck (not shown)	936	48' x 24'	-	50	40	-	-	-	-