



# WYNDHAM GRAND®

## Pittsburgh Downtown

### LOCATION

The Wyndham Grand Pittsburgh Downtown is located right in the heart of downtown Pittsburgh. Within walking distance to Heinz Field, PNC Park, the Cultural District and 80+ restaurants, bars, entertainment venues and shopping.

### FEATURES

- 24-hour fitness center with views of downtown Pittsburgh
- Indoor swimming pool and Jacuzzi® with spectacular views of Point State Park
- High-speed Internet access
- Hotel shop with sodas, snacks, Pittsburgh souvenirs, and more
- Pet-friendly hotel
- 712 guest rooms with 73 suites

### ROOM DETAILS

All rooms feature the following:

- Floor-to-ceiling window with fabulous river and/or skyline views
- Wyndham 'Be Well' bedding and guest room décor
- Gilchrist & Soames® bath products
- 37" flat-screen, HD televisions
- High-speed Internet access
- Coffee-maker with complimentary Wolfgang Puck's® coffee
- Work desk with lamp
- Hair dryer
- Iron with ironing board

### DINING AND ENTERTAINMENT

Discover a "Classic Pittsburgh" dining experience in our 3 Rivers Restaurant, featuring a delicious breakfast, lunch and dinner menu complete with many of Pittsburgh's favorite tastes. For a pre-dinner refreshment or nightcap, grab a cocktail, beer or glass of wine at one of our two lounges, 3 Rivers Lounge or Scenes Lobby Lounge. For your convenience, our exceptional room service is offered seven days a week, ensuring you won't have to leave the comfort of your stylish guest room.

### GETTING THERE



Directions From Local Airports

#### PIT - Greater Pittsburgh International Airport

Distance : 18 miles

Directions: Exit airport via Airport Blvd. Keep left at fork, follow signs for I-376 E/I-79 E/Pittsburgh/Pennsylvania Turnpike E and merge onto I-376 E. Drive approximately 17 miles on I-376 E through Fort Pitt Tunnels. Once on bridge, take exit 70A for Liberty Ave. Turn left onto Commonwealth Place. Hotel will be on your right.



### ATTRACTIONS

- Heinz Field (Pittsburgh Steelers & University of Pittsburgh)
- PNC Park (Pittsburgh Pirates)
- David L. Lawrence Convention Center
- Rivers Casino
- Market Square featuring Restaurants, bars & entertainment
- Carnegie Science Center
- The Great Allegheny Passage
- Cultural District Theaters
- Andy Warhol Museum

### MEETING SPACE HIGHLIGHTS

- 60,000 square feet of flexible meeting space with 35 total meeting rooms
- 17,280 square foot Grand Ballroom with built-in, hydraulic stage
- 10,080 square foot King's Garden Ballroom with soaring views of Point State Park
- Executive Center featuring (11) breakout rooms of varying sizes
- Comprehensive on-site Audio Visual equipment, service & capability
- Experienced Convention Services team to plan & service events

600 Commonwealth Place, Pittsburgh, PA 15222  
 Phone: 412-391-4600 Fax: 412-467-3474  
**WYNDHAM.COM / 1-800-WYNDHAM**  
 wyndhamgrandpittsburgh.com Group Sales: 888-WYNDHAM

# MEETING SPACE CAPACITY CHART

## LOBBY LEVEL - EXECUTIVE CENTER

Name Of Room	Dimensions			Classroom								Exhibits			
	LxW	Square Feet	Ceiling Height	Theater	2 per 6	3 per 6	Banquet	Half-Rds 6 per	Reception	Conf	U-shape	Hollow Square	8x10	10x10	Tabletop
Board Room	22 x 20	440	9	40	16	24	30	18	30	16	13	16	NA	NA	8
Forbes	23 x 18	414	9	36	16	24	30	18	30	16	13	16	NA	NA	8
Duquesne	23 x 37	851	9	90	36	54	70	42	70	29	26	30	NA	NA	18
Liberty	18 x 21	378	9	40	12	18	20	12	45	16	15	16	NA	NA	6
Heinz	32 x 20	640	9	72	20	30	50	30	60	28	26	30	NA	NA	10
Allegheny	32 x 20	640	9	72	20	30	50	30	60	28	26	30	NA	NA	10
Benedum	38 x 27	1,065	9	120	42	63	90	54	90	30	31	36	NA	NA	20
Stanwix	18 x 18	324	9	18	8	12	20	12	30	10	7	10	NA	NA	4
Bridges	70 x 33	2,348	11	190	90	135	150	90	220	NA	NA	NA	12	10	30
Fort Pitt	23 x 33	759	11	80	36	54	50	30	70	24	30	24	5	3	14
Smithfield	24 x 33	792	11	90	46	66	60	36	80	24	30	24	5	4	14
Birmingham	23 x 33	759	11	80	36	54	50	30	70	24	30	24	5	3	14
F.Pitt&Smithfield	47 x 33	1,551	11	140	56	84	100	60	150	36	42	36	8	6	24
Smith&Birmnghm	47 x 33	1,551	11	140	56	84	100	60	150	36	42	36	8	6	24
Sterlings	84 x 21	2,152	9	225	68	102	190	114	220	84	78	84	14	10	30
1	34 x 28	834	9	90	32	48	80	48	90	36	30	36	5	4	14
2	26 x 21	560	9	60	18	27	50	30	58	30	24	30	4	3	8
3	30 x 21	655	9	72	26	39	60	36	68	30	24	30	5	3	10
1 & 2	54 x 21	1,497	9	150	56	84	130	78	121	54	48	54	10	7	20
2 & 3	56 x 21	1,214	9	137	58	87	110	66	126	54	48	54	8	6	18
Sterlings Foyer	NA920	9	NA	NA	NA	NA	NA	50	NA	NA	NA	NA	NA	6	
Commonwealth	118 x 36	4,150	14	432	150	255	320	192	453	114	123	132	27	21	60
1	46 x 37	1702	14	177	56	84	130	78	179	36	45	54	10	8	20
2	72 x 34	2448	14	255	94	141	190	114	253	60	69	78	15	12	40

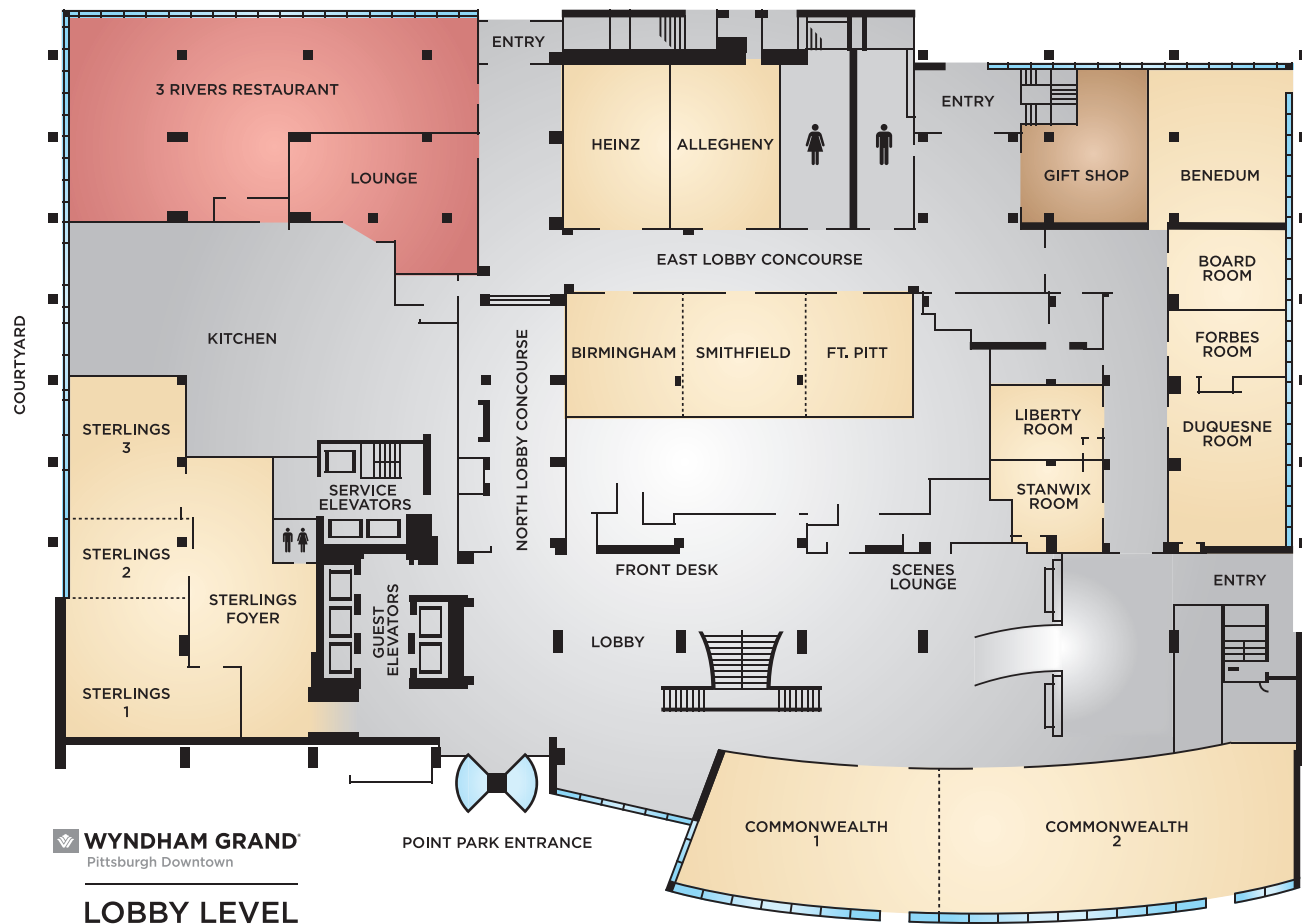

# MEETING SPACE CAPACITY CHART

## BALLROOM LEVEL - 2ND FLOOR

Name Of Room	Dimensions			Classroom								Exhibits			
	LxW	Square Feet	Ceiling Height	Theater	2 per 6	3 per 6	Banquet	Half-Rds 6 per	Reception	Conf	U-shape	Hollow Square	8x10	10x10	Tabletop
<b>Grand Ballroom</b>	144x120	17,280	19	2000	720	1080	1650	990	1850	N/A	N/A	N/A	113	109	240
Ballroom 1	58x120	6,960	19	775	290	435	660	396	740	100	92	138	48	40	98
Ballroom 2	48x120	5,760	19	675	240	360	550	330	600	100	86	124	43	32	80
Ballroom 3	34x60	2,040	19	225	80	120	150	90	220	42	58	70	10	8	28
Ballroom 4	34x60	2,040	19	225	80	120	150	90	220	42	58	70	10	8	28
Ballroom 1 & 2	106x120	12,720	19	1410	530	795	1210	726	1350	100	150	204	88	67	160
Ballroom 3 & 4	34x120	4,080	19	440	160	240	300	180	450	100	108	120	18	20	50
Ballroom 2, 3 & 4	84x120	9,840	19	1090	400	600	850	510	1040	100	129	183	60	52	138
Ballroom Foyer	135x37	4,893	9	N/A	N/A	N/A	N/A	N/A	550	N/A	N/A	N/A	11	9	40
Chartiers	27x18	486	9	50	16	24	40	24	53	22	24	30	N/A	N/A	8
Traders	25x19	475	9	50	16	24	30	18	53	22	24	30	N/A	N/A	8
Rivers	39x26	1,014	9	100	32	48	60	36	105	34	33	42	N/A	N/A	14
Black Diamond	20x19	380	9	30	12	18	30	18	40	16	18	24	N/A	N/A	6
Brigade	35x27	945	9	90	32	48	60	36	100	34	33	42	N/A	N/A	14
Kings Terrace	24x21	504	9	55	14	21	50	30	60	22	22	28	N/A	N/A	8
<b>Kings Garden Ballroom</b>	210x48	10,080	11	1000	420	630	700	420	1053	N/A	N/A	N/A	46	40	99
King's 1	39x43	1,677	11	140	58	87	90	54	170	32	30	36	7	5	26
King's 2	33x43	1,419	11	160	66	99	120	72	150	32	30	36	10	8	26
King's 3	38x43	1,634	11	140	58	87	90	54	170	32	30	36	7	5	26
King's 4	50x55	2,750	11	300	114	171	160	96	285	42	58	70	13	11	42
King's 5	50x56	2,800	11	300	114	171	160	96	295	42	58	70	15	11	42
1, 2, 3 Foyer	72x14	1,008	10	N/A	N/A	N/A	N/A	N/A	50	N/A	N/A	N/A	N/A	N/A	4
4, 5 Foyer	88x14	1,232	10	N/A	N/A	N/A	N/A	N/A	120	N/A	N/A	N/A	3	4	12

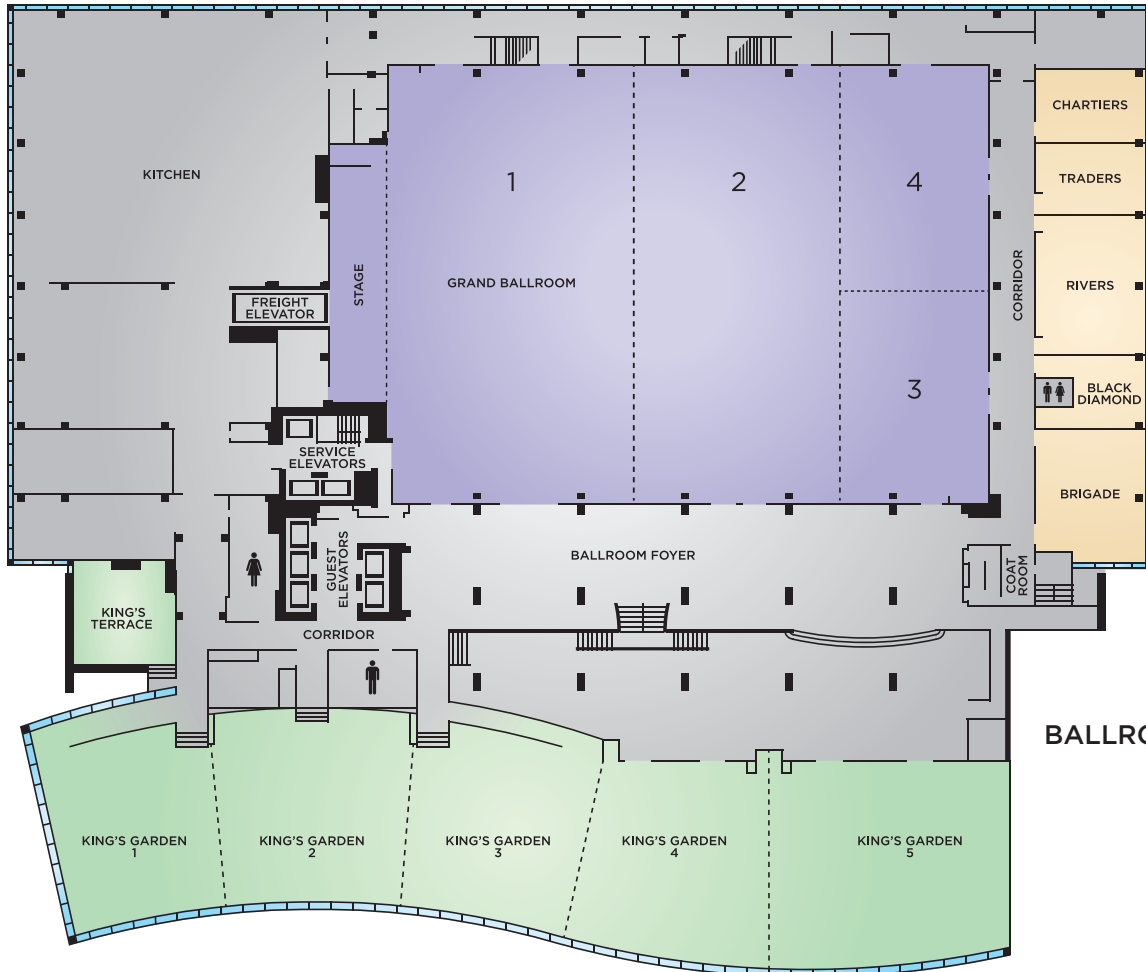

**BALLROOM LEVEL**